

**AVAILABLE
FOR LEASE**

THE PORTICO

1303 West Sixth Street , Corona, California 92882



FEATURES:

- 9,226 square foot retail strip center
- Conveniently located at high trafficked West Sixth Street and South Sherman Avenue
- Conveniently located minutes from Highway 91
- Easy access with 5 entrances and ample parking (2.78/1,000)
- Prominent building and pylon signage
- Large pergola with finished patio ideal for garden dining

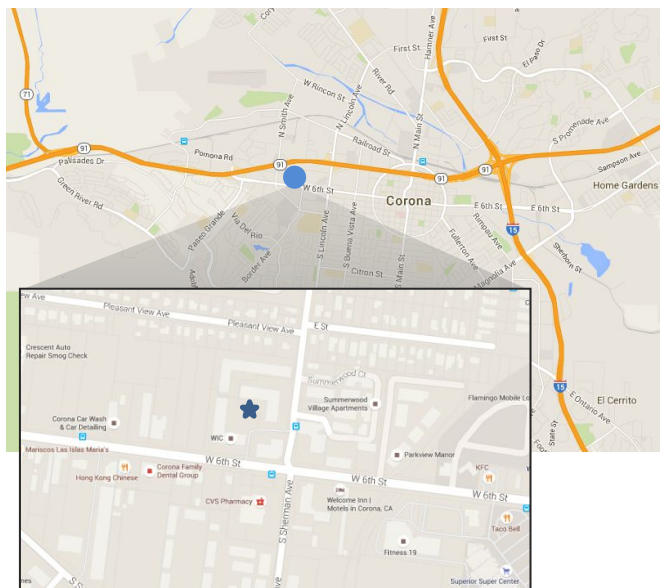

**FOR MORE
INFORMATION
PLEASE
CONTACT:**

Cal-American
1109 Westwood Blvd.
Los Angeles, CA 90024
(888) 758-4838

DEMOGRAPHIC HIGHLIGHTS

2015	1 Mile	3 Miles	5 Miles
Total Population	28,233	121,270	206,205
Average HH Income	\$67,991	\$88,241	\$94,257
Daytime Population	41,407	121,270	206,205

Source: Loopnet

TRAFFIC COUNTS

Street	Cars Per Day
South Sherman Ave.	11,500
West Sixth Street	44,300

Source: City of Corona

Cal-American
Corporation

No warranty or representation, expressed or implied, is made as to the accuracy of the information contained herein, and same is submitted subject to errors, omissions, change of price, rental, approximate square footage, or other conditions, withdrawal without notice, and to any special listing conditions, imposed by our principals.

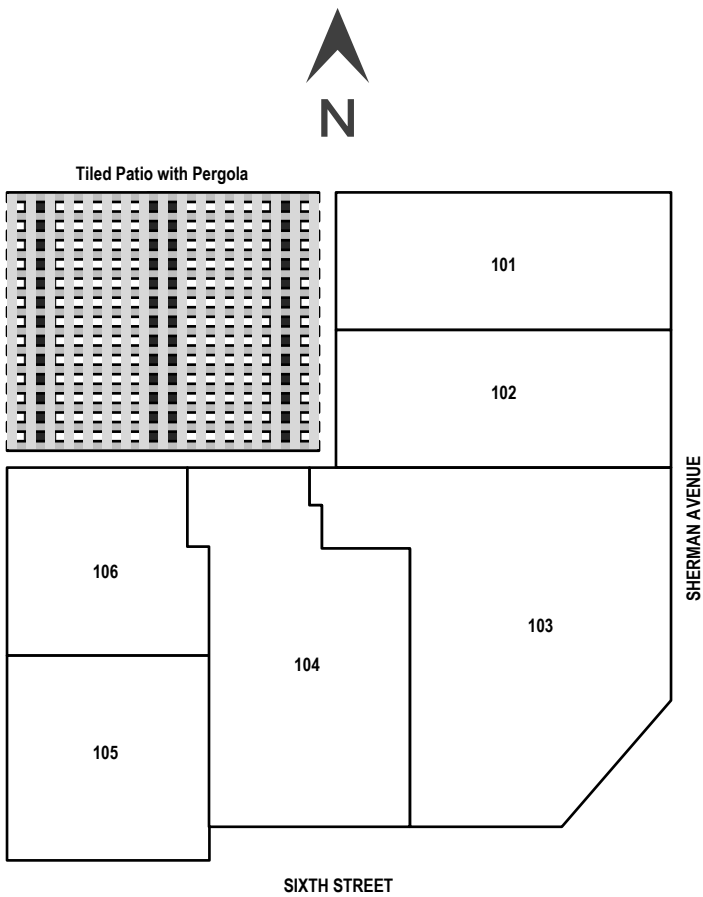

Unit	Tenant	Sq. Ft.
101	Community Medical Clinic	1,316
102	Community Medical Clinic	1,220
103	Dental Office	2,701
104	Community Medical Clinic	1,837
105- 106	Community Medical Clinic	2,088